

ROLLER TRANSFER PLATES - 85 & 115 mm VERSION

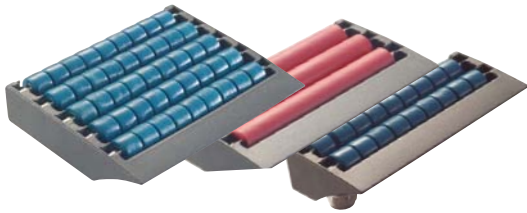

VERSION WITH 2 ROLLERS

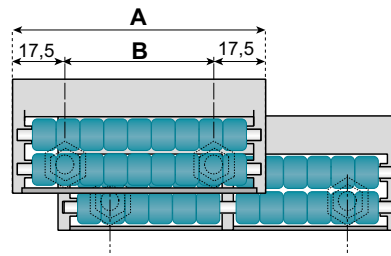
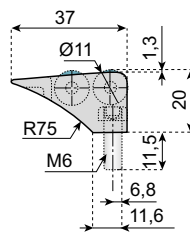

VERSION WITH 3 ROLLERS

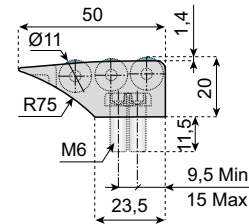

B = Center distance of fasteners

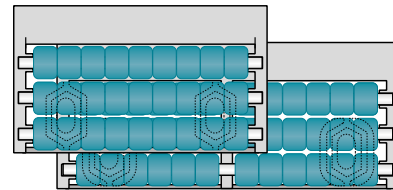

VERSION WITH 5 ROLLERS

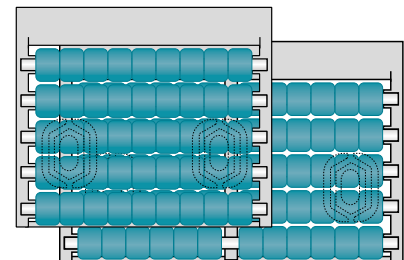
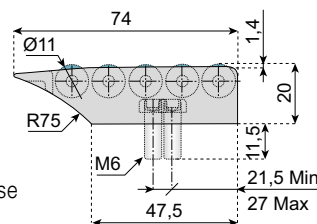





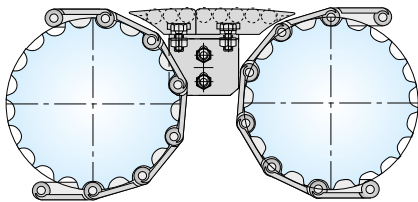











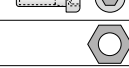

Type:

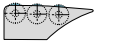
- MR** Multi rollers, suitable for irregular shaped products
- SR** Plastic rollers with noise reducing characteristics
- SSA** Plastic rollers with micro ball bearings for ultra low coefficient of friction

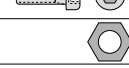

Material:

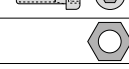
Body: Acetal thermoplastic resin
Rollers: Acetal (types MR & SSA), Thermoplastic resin with noise reducing characteristics (type SR)
 Pins, hardware and micro ball bearings (SSA only): Stainless steel

ROLLER TYPE: A=85 - B=50					ROLLER TYPE: A=115 - B=80					
 MR  SR  SSA					 MR  SR  SSA					
 WITH 2 ROLLERS					 WITH 2 ROLLERS					
Fastener M6		TME-330R2MR-FM	TME-330R2SR-FM	TME-330R2SSA-FM	TME-450R2MR-FM	TME-450R2SR-FM	TME-450R2SSA-FM	TME-450R2MR-BM	TME-450R2SR-BM	TME-450R2SSA-BM
		TME-330R2MR-BM	TME-330R2SR-BM	TME-330R2SSA-BM	TME-450R2MR-BM	TME-450R2SR-BM	TME-450R2SSA-BM	TME-450R2MR-NM	TME-450R2SR-NM	TME-450R2SSA-NM
Nut M6		TME-330R2MR-NM	TME-330R2SR-NM	TME-330R2SSA-NM	TME-450R2MR-NM	TME-450R2SR-NM	TME-450R2SSA-NM	TME-450R2MR	TME-450R2SR	TME-450R2SSA
WITHOUT SCREWS		TME-330R2MR	TME-330R2SR	TME-330R2SSA	TME-450R2MR	TME-450R2SR	TME-450R2SSA			
 WITH 3 ROLLERS					 WITH 3 ROLLERS					
Fastener M6		TME-330R3MR-FM	TME-330R3SR-FM	TME-330R3SSA-FM	TME-450R3MR-FM	TME-450R3SR-FM	TME-450R3SSA-FM	TME-450R3MR-BM	TME-450R3SR-BM	TME-450R3SSA-BM
		TME-330R3MR-BM	TME-330R3SR-BM	TME-330R3SSA-BM	TME-450R3MR-BM	TME-450R3SR-BM	TME-450R3SSA-BM	TME-450R3MR-NM	TME-450R3SR-NM	TME-450R3SSA-NM
Nut M6		TME-330R3MR-NM	TME-330R3SR-NM	TME-330R3SSA-NM	TME-450R3MR-NM	TME-450R3SR-NM	TME-450R3SSA-NM	TME-450R3MR	TME-450R3SR	TME-450R3SSA
WITHOUT SCREWS		TME-330R3MR	TME-330R3SR	TME-330R3SSA	TME-450R3MR	TME-450R3SR	TME-450R3SSA			
 WITH 5 ROLLERS					 WITH 5 ROLLERS					
Fastener M6		TME-330R5MR-FM	TME-330R5SR-FM	TME-330R5SSA-FM	TME-450R5MR-FM	TME-450R5SR-FM	TME-450R5SSA-FM	TME-450R5MR-BM	TME-450R5SR-BM	TME-450R5SSA-BM
		TME-330R5MR-BM	TME-330R5SR-BM	TME-330R5SSA-BM	TME-450R5MR-BM	TME-450R5SR-BM	TME-450R5SSA-BM	TME-450R5MR-NM	TME-450R5SR-NM	TME-450R5SSA-NM
Nut M6		TME-330R5MR-NM	TME-330R5SR-NM	TME-330R5SSA-NM	TME-450R5MR-NM	TME-450R5SR-NM	TME-450R5SSA-NM	TME-450R5MR	TME-450R5SR	TME-450R5SSA
WITHOUT SCREWS		TME-330R5MR	TME-330R5SR	TME-330R5SSA	TME-450R5MR	TME-450R5SR	TME-450R5SSA			